

elesa
Original design MDX.

- 2 Type**
- N** Without lettering
 - R** With lettering, with arrow, ascending clockwise
 - L** With lettering, with arrow, ascending counter-clockwise

Assembly instruction

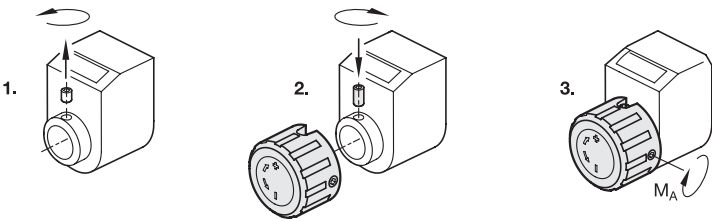

d ₁ Hollow shaft diameter of the position indicator	d ₂	d ₃	d ₄	h	Recommended torque M _A in Nm	For position indicator
14	14,5	23,5	M 3	15	0,2	GN 955 / GN 955.2
20	20,5	32	M 4	20	0,2	GN 954 / GN 954.2 / GN 9054 / GN 9154
29	29,5	41	M 4	25	0,2	GN 953 / GN 953.2 / GN 9053 / GN 9153

Specification

- Control knob**
- Plastic, Polyamide (PA)
 - Glass fiber reinforced
 - Black, matte finish
 - Operating temperature 0 °C to +80 °C

- Cover cap**
- Plastic, Polypropylen (PP)
 - Orange, RAL 2004, matte finish
 - Gray, RAL 7035, matte finish
- DOR
- DGR

- Grub screws DIN 916**
- Stainless steel
 - with internal hex and serrated point

RoHS

Technical Information	Page
Plastic Characteristics	QVX

Control knobs GN 957.1 are used in conjunction with position indicators when a control knob is to be used for adjustment. The diameter d_2 is coordinated to the hollow shaft diameter of the relevant position indicator. The set screw of the position indicator must be replaced by a longer set screw enclosed with the control knob in order to clamp the adjusting shaft. The control knob is then placed on the hollow shaft of the position indicator, with the newly inserted set screw in the recess of the control knob serving as a swivel limiting stop. With the aid of the second set screw d_4 , the control knob then is axially fixed on the hollow shaft of the position indicator with the recommended torque M_A .

see also...	Page
GN 953 GN 953.2 Position Indicators (Hollow Shaft Steel / Stainless Steel)	QVX / QVX
GN 954 GN 954.2 Position Indicators (Hollow Shaft Steel / Stainless Steel)	QVX / QVX
GN 955 GN 955.2 Position Indicators (Hollow Shaft Steel / Stainless Steel)	QVX / QVX
GN 9053 GN 9054 Position Indicators (Electronic)	QVX / QVX
GN 9153 GN 9154 Position Indicators (Data Transmission via Radio Frequency)	QVX / QVX

How to order	1 d ₁
	2 Type
	3 Color of the cover cap

GN957.1-20-N-DOR