

Version **ALS**

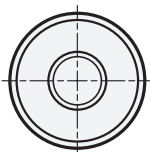

Version **KT**

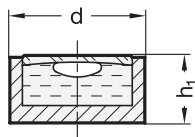
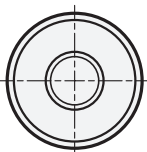
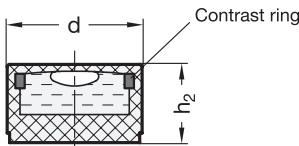

4 Sensitivity

- 10** Angle minutes, bubble move by 2 mm (only version ALS)
- 40** Angle minutes, bubble move by 2 mm (only version KT)

5 Identification no.

- 1** without contrast ring
- 2** With contrast ring (only version KT for d = 12...18)

2

d	h ₁	h ₂
10	6,9	6
12	6,4	7
14	6,2	8
15	7,4	8
18	7,3	9

Specification

Housing

- Aluminum
 - Anodized, black
 - Viewing window, glass
- Plastic
 - White
 - Viewing window, transparent

● **ALS**

○ **KT**

Filling

- Colorless-transparent
- Green-transparent (only version KT)

K
G

RoHS

On request

- Other sensitivities

Due to their cylindrical design, bull's eye spirit levels GN 2281 are suitable for installation in plates and housings where they serve to check the horizontal position of jigs, machines and devices.

Bull's eye spirits levels are not aligned, i.e. there is no reference to the external outline of the level. The vertical position must be ensured by aligning the holding building element.

The black housing of the version ALS creates a reflection at the edge of the bubble which significantly improves the readability. Version KT is available with contrast ring inside the air level housing(Identification no. 2) which creates the same effect.

Alternatively, the contrast can also be improved by a dark surface inside the mounting bore hole.

see also...

	Page
GN 2278 Bull's Eye Spirit Levels (for Insertion into Bore Holes)	QVX
GN 2277 Bull's Eye Spirit Levels (with Mounting Flange)	QVX
GN 2283 Screw-On Spirit Levels (for Mounting with Screws)	QVX
GN 2282 Screw-On Spirit Levels (for Mounting with Screws)	QVX

Technical Information

General Information on Bull's Eye, Screw-On and Cross Spirit Levels	QVX
---	-----

How to order	1 Finish / Material
	2 d
	3 Filling
	4 Sensitivity
	5 Identification no.

GN 2281-ALS-14-K-10-1