

- 3

Type
- A

 2x2 threaded blind bores
- B

 2x2 threaded studs
- C

 2x threaded studs  
(at the eccentric pin)  
2x threaded blind bores
- D

 2x threaded blind bores  
(at the eccentric pin) /  
2x threaded studs

1

2

$l_1$	$l_2$	a	b	$d_1$	$d_2$	$l_3$	$l_4$	m	t
28	64	2	14,5	M 5	8	6	12	19	7,5

Specification

- Plastic (Polyamide PA)
  - Glass fiber reinforced
  - Black, matte finish
  - Temperature resistant up to 80 °C
- Pin  
Plastic (Polyacetal POM)
- Threaded bushings  
Brass nickel plated
- Threaded studs  
Steel nickel plated
- Load Rating Information → Page 2126
- Plastic Characteristics → Page 2158
- RoHS

Information

On hinges GN 160 the two pin halves which form the fulcrum are offset from each other by 0.5 mm and therefore, eccentric. Hence the position of the door can be altered or re-adjusted in relation to the frame.

- see also...
- List of Hinge Types → Page 1284 ff.
  - Hinge GN 160.1 → Page 1386
  - Hinges GN 161.1 → Page 1382

How to order	1	$l_1$
<div><div>1</div><div>2</div><div>3</div></div> GN 160-28-64-B	2	$l_2$
	3	Type

### Construction and assembly instructions

The hinge section is to be attached to the door frame with the octagon holder.

First insert the pin such that the reference marking of the pin coincides with the arrow at the hinge.

The eccentric pin is to be placed in eight positions via the octagon.

Depending on position,  $l_1$  changes: min. 27.5 / max. 28.5.

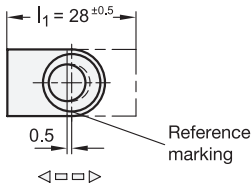
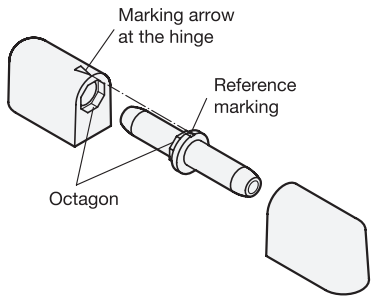

### Aligning the door

To align the door, the eccentric pin of the top and bottom hinge may be turned into the required position.

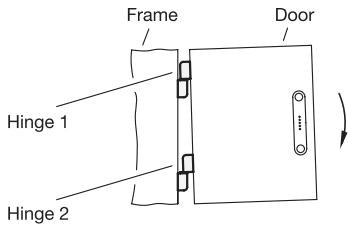

Hinge 1: Turn pin anti-clockwise  
Hinge 2: Turn pin clockwise

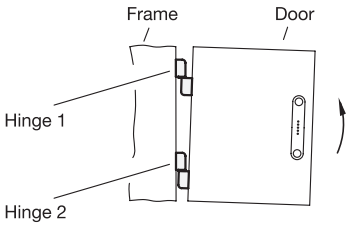

Hinge 1: Turn pin clockwise  
Hinge 2: Turn pin anti-clockwise

### Hinge layout

#### Door unhingeable

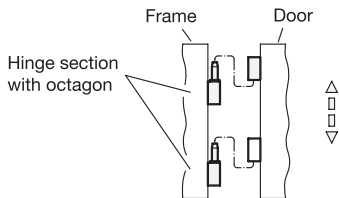

#### Door not unhingeable

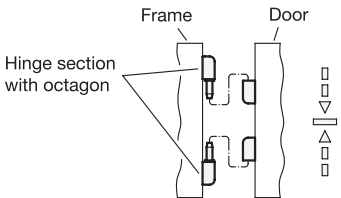

The top hinge section may be mounted to the frame only after the bottom hinge has been hung.