

- 1

Type
- DK With triangular spindle
- VK7 With square spindle
- VK8 With square spindle
- SCH With slot
- VDE With double bit

Specification

3

- Cabinet U-handle
  - Zinc die casting
  - Powder coated
  - Black, RAL 9005, textured finish
  - Silver, RAL 9006, textured finish
- Other parts
  - Steel
  - Zinc plated, blue passivated

● SW

● SR

RoHS

Accessory

- Socket Keys 119.2 → Page 1266
- Protective Guide Plates GN 120.2
  - Page 1270
- Internal Cabinet Handles GN 120.3
  - Page XYZ

Information

Latches with cabinet U-handle GN 115.7 are used when the application requires both a locking mechanism and a handle. They lock by a turning operation limited to 90° which moves the latch arm in the locked position behind the door frame. The bevels of the latch arm ease the closing of the door.

Latch arms are available with different bend angles to cover a latch arm distance A from 4 to 50 mm. The latches with cabinet U-handle GN 115.7 are supplied with loosely enclosed latch arm.

The cabinet U-handle with integrated latch arm is an attractively designed and cost-effective solution.

see also...

- List of Latch Types → Page 1196 ff.
- Latches with Cabinet U-Handle GN 119.3 → Page 1246
- Latches with Gripping Tray GN 115.10 (not Lockable) → Page 1224

How to order	1 Type
GN 115.7-SCH-20-SR	2 Latch arm distance A
	3 Finish

## Technical and assembly instructions

Depending on the installation situation, the 90° turning range of the latch arm can be defined by means of a plug-type element, which can be mounted in 4 different positions.

This allows the latch with U-handle to be used in any attachment position and regardless of the turning and locking direction or of the narrow side of the door. Subsequent repositioning of the 90° rotary range is possible, if necessary.

The possible plugging options and the resulting 90° rotary ranges are shown in the outline drawing.

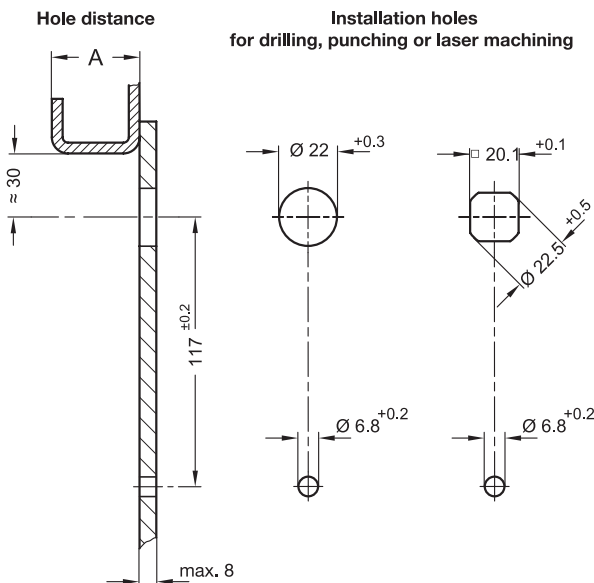
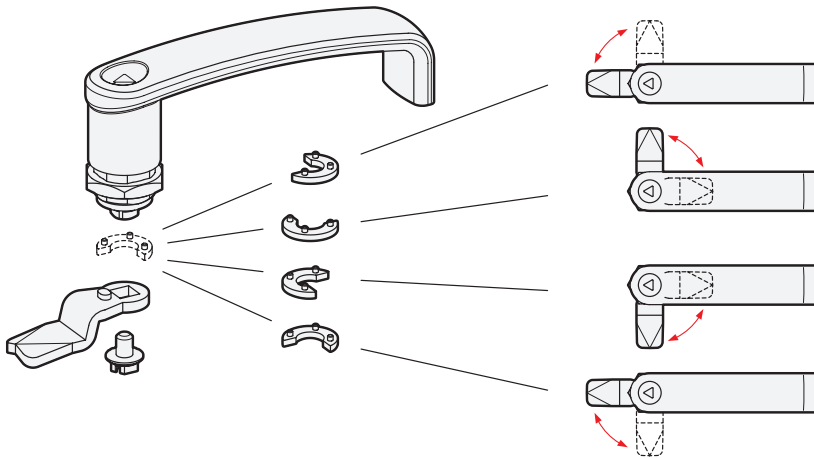

For installation, the door, cover or hatch is fitted with two holes according to one of the two outline drawings.

If preassembled (cabinet U-handle including latch arm), the latch can be inserted through the hole from the front. The mounting nut can then be pushed over the latch from the back and bolted in place. The second end of the cabinet U-handle is secured with an M6 mounting screw (not included). Finally, both elements are tightened.

The required installation holes in the door leaf, is usually generated by punching or laser machining in series production.